

'B' BUSH REFERENCE CHART TYPE

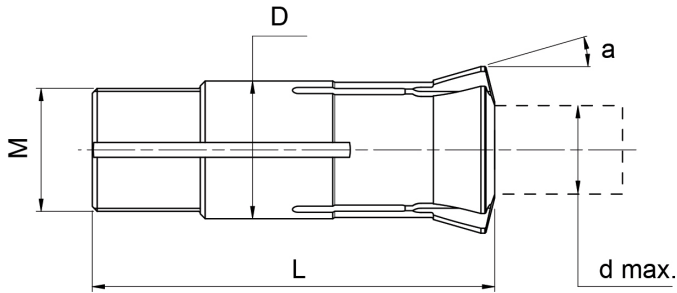

Reference Number	Dimensions				Minimum Capacity			Maximum Capacity		
	FLOYD	BODY Ø (mm)	LENGTH (mm)	THREAD	CONE	Ø (mm)	HEX (mm)	SQ (mm)	Ø (mm)	HEX (mm)
J2	7	30	6 x 0.5	16°	0.31	1.0	1.0	3.5	3.0	2.5
B201	9	50	8 x 0.6	30°	0.31	1.0	1.0	5.0	4.5	2.5
J3	9	44	8 x 0.75	16°	0.31	1.0	1.0	5.0	4.5	3.0
1352	11	53	10 x 0.8	16°	0.5	1.0	1.0	7.5	6.0	4.0
J4	11	53	10 x 0.75	16°	0.5	1.0	1.0	7.5	6.0	5.0
B211	12	50	12 x 1.0	30°	0.5	1.0	1.5	8.0	6.5	5.5
J5	12	50	10 x 0.75	16°	0.5	1.0	1.5	7.5	6.0	5.0
B300	13	41.5	12.5 x 0.75	15°	0.7	1.0	1.5	8.0	7.0	5.0
B304	14	64	13 x 0.75	16°	0.7	1.0	1.5	8.0	7.0	5.5
B203	16	61	15 x 1.0	19°	0.7	1.5	1.5	11.0	9.5	8.0
1353	16	59	14 x 1.0	16°	0.7	1.5	1.5	10.5	9.0	7.5
J6	16	58	14 x 1.0	16°	0.7	1.5	1.5	10.5	9.0	7.5
B212A	18	59	16 x 1.0	30°	1.0	1.5	2.0	12.0	11.0	9.0
Top 100	18	100	18 x 1.0	20°	1.0	1.5	3.0	13.0	11.0	9.0
B208	20	55	20 x 1.0	30°	1.0	1.5	2.0	13.0	11.0	9.0
N800	21	57.5	18 x 1.0	12°	1.5	2.0	2.0	11.0	9.5	8.0
J7A	22	68	19 x 1.0	16°	1.5	2.0	2.0	16.0	14.0	11.0
39.001	22	68	22 x 1.0	16°	1.5	2.0	2.0	18.0	15.0	13.0
B238	24	61	24 x 1.0	30°	1.5	2.0	2.0	16.0	14.0	11.0
B302	27	57.5	24 x 1.0	12°	2.0	2.5	3.0	16.0	14.0	11.0
B260	28	81	25 x 1.0	30°	2.0	2.5	3.0	20.0	18.0	15.0
B261	28	82	25 x 1.0	16°	2.0	2.5	3.0	20.0	18.0	15.0
B261R*	28	82	27 x 1.0	16°	20.0	17.0	15.5	23.0	19.5	16.0
B261R*	28	82	28 x 1.0	16°	20.0	17.0	15.5	24.0	22.5	16.5
B214	32	71	32 x 1.0	30°	2.5	2.5	3.0	22.00	19.0	15.0
N227	34	87.5	34 x 1.0	10°	2.5	3.0	4.0	25.0	22.0	18.0
Top 200	34	150	32 x 1.5	20°	3.0	3.0	4.0	26.0	22.0	18.0
B207	40	71	40 x 1.0	30°	3.0	3.0	4.0	30.0	26.0	20.0
B207A	40	72	36 x 1.0	30°	3.0	4.0	4.0	26.0	22.0	20.0
N229	42	82	40 x 1.0	16°	4.0	4.0	4.0	32.0	26.0	20.0
N229R*	42	82	42 x 1.0	16°	32.0	27.0	21.0	36.0	30.0	24.0
B48	48	82	46 x 1.0	16°	-	-	-	38.0	-	-

These Guide Bushes are reinforced oversized bushes. Special or modified nuts will be required. These are supplied with **NO GUARANTEE**.