

CANONS DE GUIDAGE A GALETS EN METAL DUR, AVEC SYSTEME DE LUBRIFICATION
FÜHRUNGSBÜCHSEN MIT HARTMETALLROLLEN, MIT SCHMIERSYSTEM
GUIDE BUSHES WITH CARBIDE ROLLERS, WITH LUBRICATING SYSTEM

Type de canon

Führungsbüchse-Typ

Guide bush type

D

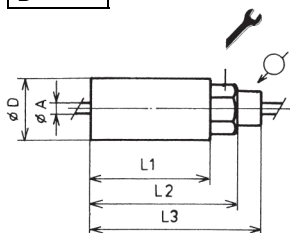

	øA	øD	L1	L2	L3	Wrench
D 15	1.59 - 3.37	15	35	59	71	10
D 18	3.38 - 4.76	18	35	59	71	12
D 22	4.77 - 5.67	22	40	59	73	14
D 25	5.68 - 7.36	25	45	59	73	17
D 30	7.37 - 10.45	30	50	62	76	22
D 35	10.46 - 18.10	35	55	67	81	25
D 40	18.11 - 22.00	40	60	72	86	30
D 50	22.01 - 26.00	50	65	79	93	36

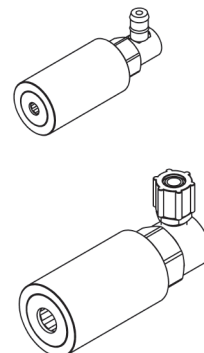

LD

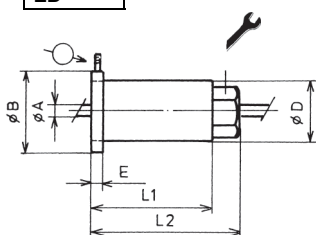

	øA	øD	L1	L2	øB	E	Wrench
LD 15	1.59 - 3.37	15	35	59	25	5	10
LD 18	3.38 - 4.76	18	35	59	28	5	12
LD 22	4.77 - 5.67	22	40	59	32	5	14
LD 25	5.68 - 7.36	25	45	59	35	5	17
LD 30	7.37 - 10.45	30	50	62	40	6	22
LD 35	10.46 - 18.10	35	55	67	45	6	25
LD 40	18.11 - 22.00	40	60	72	50	6	30
LD 50	22.01 - 26.00	50	65	79	60	6	36

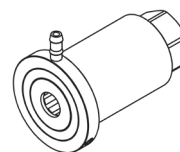

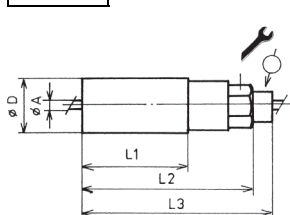

EXT



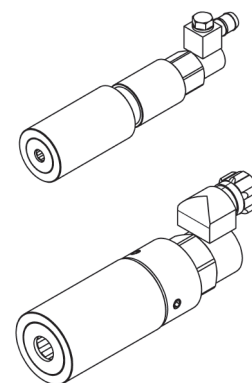

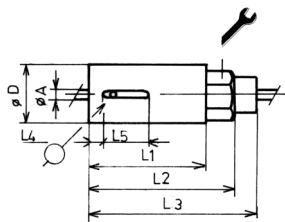
	øA	øD	L1	L2	L3	Wrench
EXT 15	1.59 - 3.37	15	35	81	93	10
EXT 18	3.38 - 4.76	18	35	81	93	12
EXT 22	4.77 - 5.67	22	40	81	93	14
EXT 25	5.68 - 7.36	25	45	84	98	17
EXT 30	7.37 - 10.45	30	50	84	98	22
EXT 35	10.46 - 18.10	35	55	84	98	25



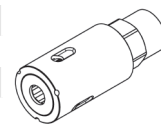
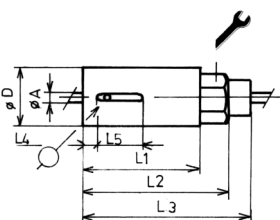

CNC

	$\varnothing A$	$\varnothing D$	L1	L2	L3	L4	L5	
CNC 15	1.59 - 3.37	15	35	59	71	5	12	10
CNC 18	3.38 - 4.76	18	35	59	71	11.5	12	12
CNC 22	4.77 - 5.67	22	40	59	73	11.5	12	14
CNC 25	5.68 - 7.36	25	45	59	73	11.5	12	17
CNC 30	7.37 - 10.45	30	50	62	76	10.5	14	22
CNC 35	10.46 - 18.10	35	55	67	81	10.5	14	25
CNC 40	18.11 - 22.00	40	60	72	86	10.5	14	30
CNC 50	22.01 - 26.00	50	65	79	93	10.5	14	36

**EN**

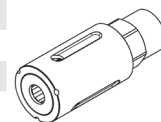
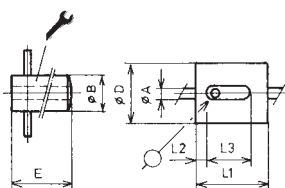
	$\varnothing A$	$\varnothing D$	L1	L2	L3	L4	L5	
EN 15	1.59 - 3.37	15	35	59	71	11.5	15	10
EN 18	3.38 - 4.76	18	35	59	71	11.5	15	12
EN 22	4.77 - 5.67	22	40	59	73	11.5	25	14
EN 25	5.68 - 7.36	25	45	59	73	11.5	30	17
EN 30	7.37 - 10.45	30	50	62	76	10.5	32	22
EN 35	10.46 - 18.10	35	55	67	81	10.5	32	25
EN 40	18.11 - 22.00	40	60	72	86	10.5	32	30
EN 50	22.01 - 26.00	50	65	79	93	10.5	32	36

**C**

	$\varnothing A$	$\varnothing D$	L1	L2	L3	$\varnothing B$	E	
C 15	1.59 - 3.37	15	27	10	6	11	45	C 15
C 18	3.38 - 4.76	18	30	10	9	14	60	C 18
C 22	4.77 - 5.67	22	32	10	12	17	60	C 22
C 25	5.68 - 7.36	25	36	10	15	19	60	C 25
C 30	7.37 - 10.45	30	40	10	19	23	60	C 30
C 35	10.46 - 18.10	35	42	10	22	27	60	C 35
C 40	18.11 - 22.00	40	50	10	27	32	80	C 40
C 50	22.01 - 26.00	50	55	10	30	38	80	C 50
C 66	26.01 - 32.00	66	60	10	30	45	80	C 66

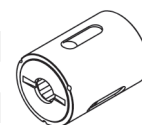

- La clé de réglage du canon C est pré-guidée sur la matière, il est donc nécessaire d'avoir une clé par diamètre de passage de barre.
 Der Einstell-Schlüssel für Büchse C wird auf dem Material vorgeleitet. Man muss deshalb für jeden Materialdurchlass einen Schlüssel vorrätig halten.
 The setting key for C bush is pre-guided on the material bar. Therefore it is necessary to hold one key per material diameter.

**PORTE-CANONS
BÜCHSENHALTER
BUSH HOLDERS**

Pour tour
Für Automaten
For lathe

Type de canon
Führungsbüchse-Typ
Guide bush type

TORNOS	
ENC - 16 / 162 / 164	EXT
ENC - 26 / 262 / 264 / TOP 200	EN / C
ENC - 74 / 75	CNC / C
ENC - 163 / 167	CNC / C
DECO 2000 - 7/10	CNC / C
DECO 2000 - 13	C
DECO 2000 - 20	CNC / C
DECO 2000 - 26	CNC / C
DECO Sigma 20	CNC / C
DECO Sigma 32	CNC / C SP. Ø 26.00 - Ø 32.00

MANURHIN	
Swing 13	CNC / C
Swing 20	CNC / C
Twin	CNC / C
K'MX 20/26	LD
K'MX 413	CNC / C

STAR	
RNC 16	CNC / C
SW 7R / SW10	CNC / C
SH 7/12/16	CNC / C
SE 7/12/16	CNC / C
SA 12/16	CNC / C
SB 16	CNC / C
SV 12	CNC / C
SV 20	CNC / C
SV 32 / SV 32-J	CNC / C SP. Ø 26.00 - Ø 32.00
SR-10J	CNC / C
SR 16 / SR 20R	CNC / C
ECAS 12 / 20	CNC / C

TSUGAMI	
NP4	CNC / C
NP17	CNC / C
BW07 / BW12	CNC / C

Pour tour
Für Automaten
For lathe

Type de canon
Führungsbüchse-Typ
Guide bush type

CITIZEN	
L16	EXT
L 20	CNC / C
L20 V - VII - VIII	CNC / C
M12	CNC / C
M16	CNC / C
M20	CNC / C
M32	CNC / C
K12 / K16	CNC / C
C 16	CNC / C
R 04	CNC / C
R 07	CNC / C

TRAUB	
TNL 7 / 12	CNC / C
TNL 16	CNC / C
TC 32 HOEFLIGER	CNC / C

HANWHA	
SL 16 S	CNC / C
XD 20 H	CNC / C
SL 20 HP II	CNC / C
STL 32 H / STL 32 J	CNC / C SP. Ø 26.00 - Ø 32.00

NEXTURN	
SA 18	CNC / C
SA 32	CNC / C SP. Ø 26.00 - Ø 32.00

MICROSWISS	
MST-07	CNC / C

GILDEMEISTER	
GLD 16 / 22	CNC / C
SPEED 12	CNC

- L'utilisation du canon type CNC, EN ou C est possible avec les porte-canon de notre fabrication uniquement.
Die Anwendung der Führungsbüchsen Typ CNC, EN oder C ist nur mit den Büchsenhaltern unserer Herstellung möglich.
The use of guide bushes type CNC, EN or C is only possible together with the bush holders of our own make.
- Notre site internet vous renseigne sur les nouvelles fabrications de porte-canon.
Unsere Web-Seite gibt Ihnen Bescheid über die neuen Herstellung von Büchsenhaltern.
Our home pages gives you information about our new productions of bush holders.