

THE KNURLING WHEEL – DIN 403

The DIN 403 is the standard for the knurling profile on the knurling wheel. The DIN 403 specifies the knurl profiles AA, BL, BR, GE, GV, KE and KV. Knurling wheels with profiles other than the ones described in the DIN 82, are classified as customized knurling wheels and are manufactured by Hommel + Keller according to customer drawings.

AA Knurling wheel with straight pattern

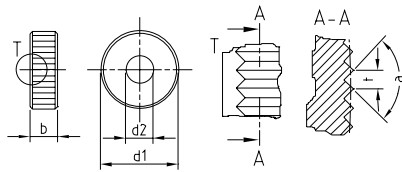

BL Knurling wheel, left-hand spiral

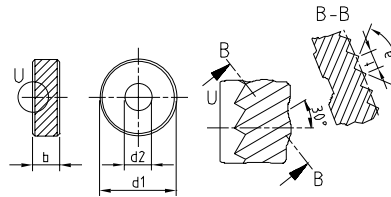

BR Knurling wheel, right-hand spiral

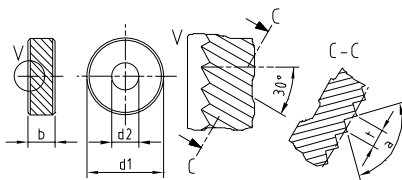

GE Cross-knurling wheel, points up, 30°, male

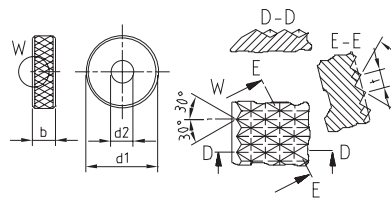

GV Cross-knurling wheel, points down, 30°, female

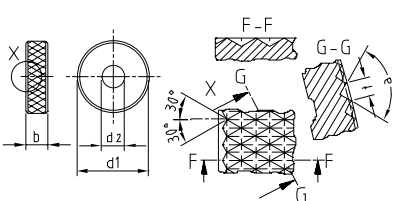

KE Square knurling wheel, crossed, points up, 90°, male

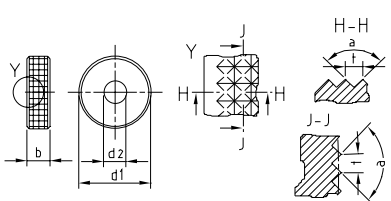

KV Square knurling wheel, crossed, points down, 90°, female

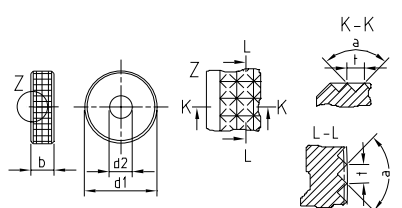

The appropriate knurling wheel's profile depends on the required profile on the work piece according to DIN 82 and the knurling tool applied. The product details from page 15 onwards, suggests the appropriate knurling wheel according to the application.