



OVERGRIPPING COLLET

Over gripping collets are specially designed pick up collets that open sufficiently to grip a component behind a shoulder. The collets are designed for each application, and the amount that that the collet can open is limited by the stroke of the collet clamping mechanism.

The general rule is that the increase in diameter is less than or equal to the stroke length. Depending on the machine, it is sometimes possible to modify the stroke length to allow the collet to open further.

These collets do not require a special collet nose cap.

In the event that over gripping collets cannot be used, we recommend the Swisscollet MASTER-Clamp Solution.

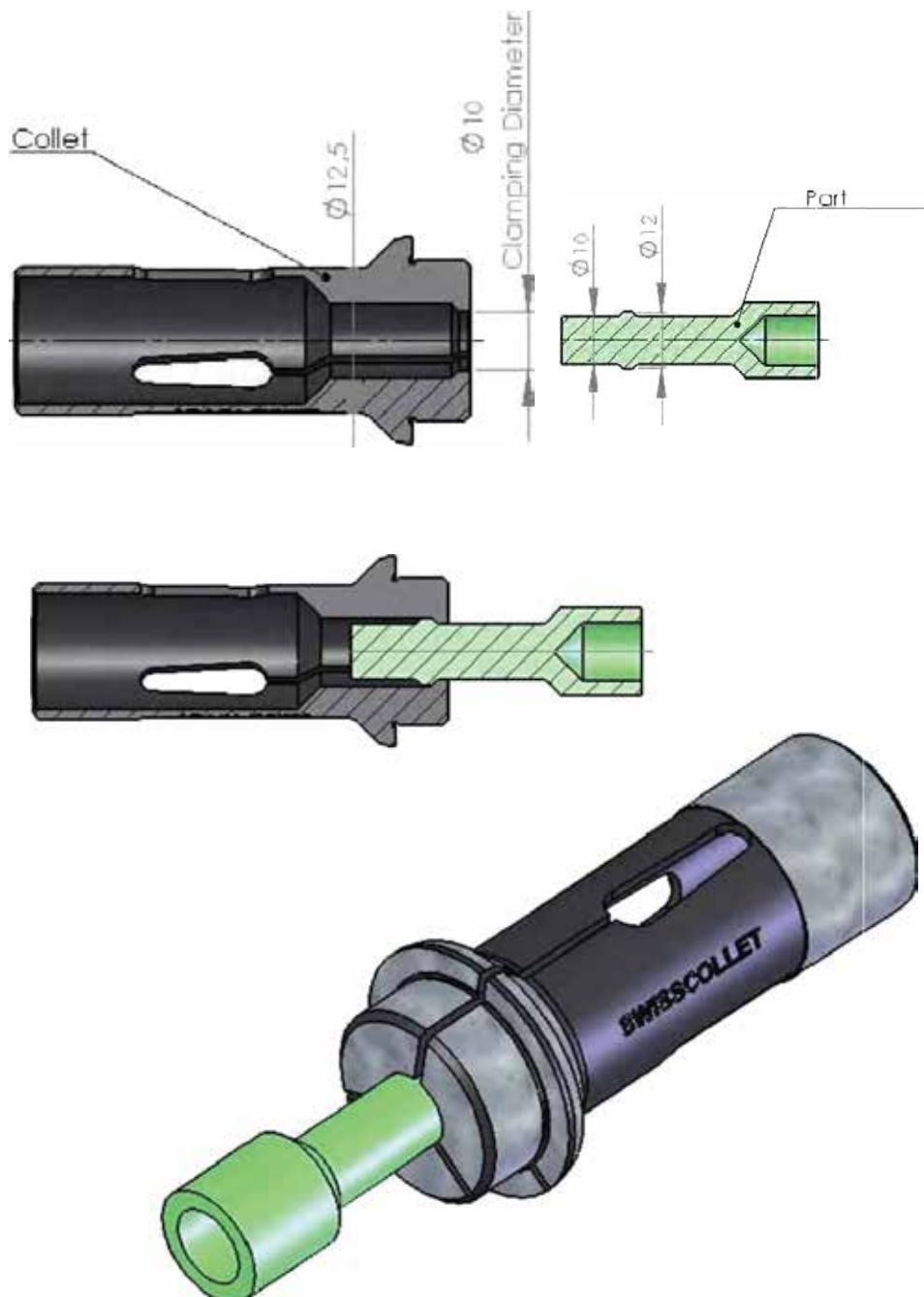

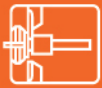

THE TOOLING SPECIALISTS FOR PRECISION COMPONENT MACHINING

F-TYPE COLLET FOR OVERGRIPPING

Client Ref:	
Enquiry No.:	
Floyd Order No.:	

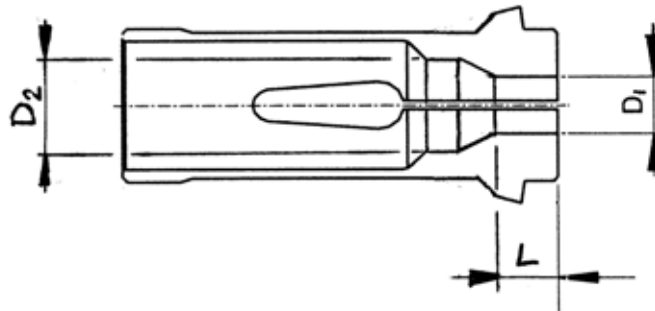

COLLET TYPE:	
BORE Ø 'D1' = (gripping dia.)	
BORE Ø 'D2' = OVERGRIPPING DIA. (please give dia. collet is to clear. This will be plus on that dia.)	
LENGTH OF BORE 'L' = (gripping length)	
ADDITIONAL INFORMATION I.E. KEYWAY DETAIL ETC.	

Please complete form and fax back on 01462 490835