

Centre height adjustment for zeus® Knurling Tools 241-20/25M 250608-A1

1. Center height adjustment for shank size 20x20 mm

Centre height is upper shank side, nominal size 20 mm is even with division mark and upper shank side.

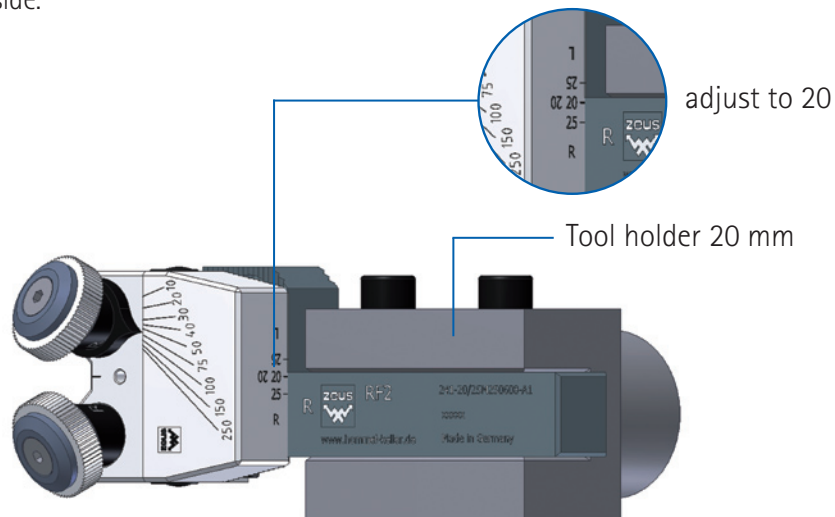

2. Center height adjustment for shank size 25x25 mm

To adjust center height for shank size 25 mm, the cut knurling head is moved upwards by means of the setting spindle. Nominal size 25 is even with division mark and upper shank side. Place a 5 mm shim between top of shank and tool holder. Note: The shim always has to be placed on top of the shank!

